



Quick Start Guide

DIGEX N450 / N455
Digital Night Vision Riflescopes

ENGLISH / FRANÇAIS / DEUTSCH / ESPAÑOL / ITALIANO / РУССКИЙ

- EN** For detailed information about the device, please download the complete user manual:
<https://www.pulsar-nv.com/glo/products/33/night-vision-riflescopes/pulsar-digex-n>
- FR** Pour des informations détaillées sur la lunette, prière de télécharger le manuel complet d'utilisation:
<https://www.pulsar-nv.com/glo/products/33/night-vision-riflescopes/pulsar-digex-n>
- DE** Für detaillierte Informationen über das Gerät, bitte das vollständige Handbuch herunterladen:
<https://www.pulsar-nv.com/glo/de/produkte/57/nachtsichtzielfernrohre/pulsar-digex-n>
- ES** Para obtener información detallada acerca del dispositivo, descargue el manual de usuario al completo:
<https://www.pulsar-nv.com/glo/products/33/night-vision-riflescopes/pulsar-digex-n>
- IT** Per informazioni dettagliate sul dispositivo, scaricare il manuale d'uso completo:
<https://www.pulsar-nv.com/glo/products/33/night-vision-riflescopes/pulsar-digex-n>
- RU** Для получения подробной информации о приборе скачайте полное руководство по эксплуатации:
<https://www.pulsar-nv.com/glo/ru/produkty/44/pricely-notchnogo-videnija/pulsar-digex-n>



DIGEX

Quick Start Guide

Digital Riflescope Digex N450/ N455	1-7	ENGLISH
Viseur digital Digex N450/ N455	8-14	FRANÇAIS
Digitales Zielfernrohr Digex N450/ N455	15-21	DEUTSCH
Visor digital Digex N450/ N455	22-28	ESPAÑOL
Cannocchiale digitale Digex N450/ N455	29-35	ITALIANO
Цифровой прицел Digex N450/ N455	36-42	РУССКИЙ

Attention! Digex Riflescopes require a license if exported outside your country.

Attention! Les viseurs **Digex** nécessitent une licence s'ils sont exportés hors de votre pays.

Achtung! Zielfernrohre **Digex** benötigen eine Lizenz, wenn sie außerhalb Ihres Landes exportiert werden.

Atención! Los visores **Digex** requieren una licencia si se exportan fuera de su país.

Attenzione! I cannocchiali **Digex** necessitano una licenza se esportati al di fuori del proprio paese.

Внимание! Прицелы **Digex** требуют лицензии, если они экспортируются за пределы Вашей страны.

Package contents

- Digex Digital Rifle scope
- APS2 rechargeable battery (3 pcs.)
- APS battery charger
- Mains charger
- USB cable
- IR illuminator
- Carrying case
- Lens-cleaning cloth
- Quick operation manual
- Warranty card
- APS3 battery cover
- Allen wrench

Charging the battery

Digex digital night riflescopes come with a built-in rechargeable lithium-ion APS3 Battery Pack with a capacity of 3200 mAh and a removable rechargeable lithium-ion APS2 Battery Pack with a capacity of 2000 mAh. The batteries should be charged before the first use.

- Open the Micro-USB cover (9) by turning it counterclockwise.
- Attach the Micro-USB plug of the USB cable (16) to the Micro-USB port (10) in the body of the rifle scope.
- Attach the second Micro-USB plug of the USB cable (16) to the USB port on the mains adapter (17). Plug the device into a 100-240 V socket (18).

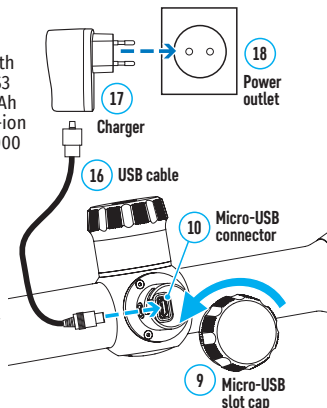

ATTENTION. When charging batteries via the Micro-USB port (10) in the body casing of the rifle scope, the built-in APS3 Battery Pack is the first to be charged. When it is completely charged, the removable APS2 Battery Pack begins charging. When the device is in use, power consumption occurs in reverse sequence.

The rechargeable APS2 lithium-ion Battery Pack can be recharged using the APS charger*.

- Insert the APS2* rechargeable battery (8) along the rail into the APS charger slot (13) as far as it will go. The APS charger is supplied with your device or sold separately.

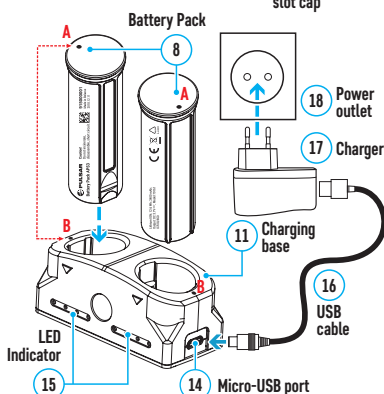

- Point A on the battery and point B on the charger should match.
- Two batteries can be charged at the same time: the second slot is designed for this.

Attach the plug of the USB cable **(16)** to the USB port on the mains adapter **(17)**. Plug the device into a 100 - 240 V socket **(18)**.

- Attach the Micro-USB plug of the USB cable to the port **(14)** of the battery charger **(13)**.
- The LED indicator **(15)** will display battery charge status (see Table).

*Supplied as part of package. The use of an APS3 rechargeable battery (sold separately) is possible.

LED Indicator*	Battery charge status
●	The battery is charged from 0% to 10%. The charger is not connected to the mains.
☀	The battery is charged from 0% to 10%. The charger is connected to the mains.
● ● ● ●	The battery is defective. It is forbidden to use the battery.
●	The battery is charged from 10% to 20%.
● ●	The battery is charged from 20% to 60%.
● ● ●	The battery is charged from 60% to 95%.
● ● ● ●	The battery is completely charged and can be disconnected from the charger.

*The LED indicator displays the current battery charge status for 30 seconds when the APS charger is not plugged in. When the power is being supplied, the indicator is constantly displaying the current battery charge status, the LEDs are additionally flickering to display the battery charging process.

⚡ Installing the rechargeable battery in riflescope

- Turn the battery cover **(7)** counterclockwise and remove it.
- Install the battery **(8)** into the battery compartment along the special guides in the device body designed for it.
- When properly installed, the battery is fixed in the battery compartment of the device.
- Cover the battery compartment **(7)**, turning it clockwise.

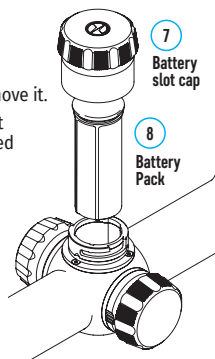

IR illuminator

The riflescope is equipped with a built-in IR illuminator featuring a wavelength of 940 nm or 850 nm which provides significant increase in observation range in lowlight conditions and in the darkness.

Installing the battery in IR-illuminator

The IR illuminator for Digex riflescope is powered by APS2 battery.

- To install the battery in the IR illuminator, turn the battery cover **(21)** counterclockwise and remove it.
- Install the battery into the battery compartment **(20)** along the special guides in the IR illuminator body designed for it.
- When properly installed, the battery is fixed in the battery compartment.
- Cover the battery compartment **(20)**, turning the battery cover **(21)** clockwise.

IR Operating Mode	Indicator color
Light on, the battery charge is 10% to 100%	Green LED (23) is on
Light on, the battery charge is 0% to 10%	Red LED (23) is on
Light off	LED (23) is off

Installing the IR illuminator

- Open the mount ring **(24)** of the IR illuminator.
- Put the mount on the riflescope body so that the mount half rings encircle the riflescope body.
- Raising the eccentric lever **(26)**, move it to the left. Align the eccentric axis **(25)** with the groove of the moving half ring. The eccentric lever must take its mounting seat.
- Lock the position of the eccentric lever by lowering it down.
- The mount with IR illuminator should be located as close as possible to body of the riflescope lens.
- Tighten the screw located on the eccentric pin using an hex-nut wrench. It is a one-time adjustment. There is no need of afterfixing the screw.

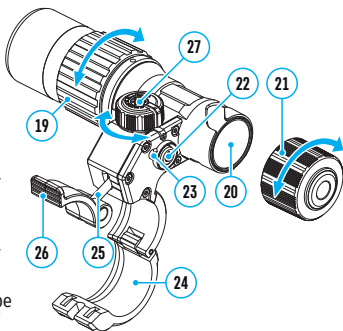

Switching on and adjusting the IR illuminator

Turn on a built-in IR illuminator to improve the quality of observation in lowlight conditions at night.

- Turn on the IR illuminator by pressing the button **(22)** on the side of the light housing.
- To adjust the output optical power, use the IR illuminator knob **(27)** located on top of the IR light housing.
- Turn the knob clockwise to increase the light power. Turning the knob counterclockwise decreases the light power.

- To adjust the position of the light spot in the field of view, loosen the IR illuminator ring (19).
- Use the hinge system of the IR illuminator lens, to achieve the required position of the light spot in the field of view of the riflescope. Once well adjusted, fix the IR illuminator ring.

⚡ Starting operation

Switching on and image setting

- Remove the lens cover (12). Switch the device on with a short press of the **ON** button (3). An image will appear on the display.
- Adjust the sharp resolution of the reticle and symbols on the display by rotating the diopter adjustment ring (2).
- Rotate the lens focus ring to focus on the object being observed (11).
- Adjust the brightness, display contrast, and smooth digital zoom using the Controller (6). For further details, see the “**Quick menu functions**” section of the full version of the manual.
- To increase the quality of observation in lowlight conditions at night, turn on the IR illuminator by briefly pressing the IR button (22). Adjust the light power by turning the IR illuminator knob (27).
- After use, turn off the riflescope by long pressing the ON/OFF button (3). Turn off the IR illuminator by pressing the IR button (22).

⚡ Components and controls

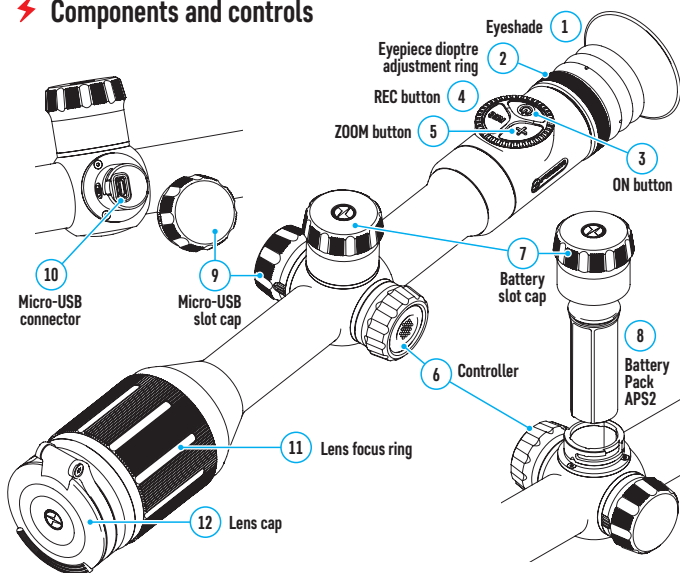

Description of controls

Control	Condition / Operating Mode	First short press	Subsequent short presses	Long press	Rotation
ON button	Device is switched off	Switch device on	SumLight On	Switch device on	-
	Display off	Activate display	SumLight On	Switch device off	-
	Device is switched on, quick menu, main menu	SumLight On	SumLight Off	Deactivate display/ Switch device off	-
ZOOM button	Device is switched on, quick menu, main menu	Magnification changing (Zoom)		PiP activation/ deactivation	-
REC button	Device is switched on, quick menu, main menu, video mode	Start video recording	Pause	Switch video / photo modes	-
	Device is switched on, quick menu, main menu, video recording activated	Pause	Start video recording	Stop video recording	-
	Device is switched on, quick menu, main menu, photo mode	Take a photograph		Switch video / photo modes	-
Controller	Device is switched on	Access quick menu	-	Access main menu	-
	Quick menu	Upwards navigation		Exit from quick menu	Change value
	Main menu	Confirm value, enter menu items		Exit from menu items, exit from main menu	Navigation through menu

Mounting on the weapon

To ensure accurate shooting the **Digex** riflescope should be properly mounted on the gun.

The riflescope is fixed using the mount, which is purchased separately according to the type of gun used. Use only high-quality mounts and rings that are designed especially for your gun.

The riflescope should be mount as low as possible but should not contact with the barrel or receiver. Before securing the fastening rings, ensure that the riflescope provides the necessary exit pupil distance and enables you to see the entire field of view.

Attention! Keep the distance of the anchor relative to the exit pupil in order to avoid recoil injury.

Stream Vision App

Download the Stream Vision app to stream the image via Wi-Fi from your Digex device to a smartphone or tablet.

The detailed user manual is available at: pulsar-vision.com



Specifications

MODEL	DIGEX N450	DIGEX N455
SKU	76641	76642
OPTICAL SPECIFICATIONS		
Lens focus, mm	50	
Focal ratio, D/f'	1:1.2	
Magnification, x	4-16 (digital zoom)	
Field of view (horizontal), °/m@100 m	6.5/11.4	
Eye relief, mm	50	
Close-up range, m	5	
Diopter adjustment, D	-3/+5	
Detection distance of an animal 1.7 m high, m/ y	550 (600)	500 (550)
ELECTRONIC CHARACTERISTICS		
Sensor type/resolution	HD CMOS/1280x720	
Display Type / Resolution	AMOLED/1024x768	
DETACHABLE IR ILLUMINATOR		
Type / Wavelength, nm	LED / 850	LED / 940
VIDEO RECORDER		
Video / photo resolution, pixel	1024x768	
Video recording / photo format	.mp4 / .jpg	
Built-in memory	16 Gb	
WI-FI CHANNEL		
Frequency	2.4 GHz	
Standard	802.11 b/g	
OPERATING FEATURES		
Power supply, V	3.0-4.2	
Battery type/Capacity/ Rated Output Voltage	Li-Ion Battery Pack APS2 / 2000 mAh / DC 3.7 V APS3 / 3200 mAh / DC 3.7 V	
External power supply	Micro USB type B (5 V)	
Maximum recoil power on a rifled weapon (Joules)	6000	
Maximum recoil power on a smooth-bore weapon (calibre)	12	
Degree of protection, IP code (IEC60529)	IPX7	
Operating temperature, °C / °F	-25...+50 / -13...+122	
Dimensions, mm / inch	378x78x78 / 14.9x3.1x3.1	
Weight (with batteries), kg / oz	0.95/ 33.5	

Improvements may be made to the design of this product to enhance its user features.

The current version of the Operation Manual can be found on the website pulsar-vision.com